

# SERVICE BULLETIN

## PAPER MACHINERY CORPORATION

ADDRESS 8900 West Bradley Road Milwaukee, WI 53224-2822 · MAILING P.O. Box 240100 Milwaukee, WI 53224-9005  
 TELEPHONE 414-354-8050 · MAIN FAX 414-354-8614 · SERVICE FAX 414-354-1710 · WEBSITE [www.papermc.com](http://www.papermc.com)

### BOTTOM FINISH ASSEMBLY

No. 221.1

#### THREAD LOCKING COMPOUND 1000, 1001, 1002, 1250

Field reports have indicated that the screw securing the washer to the roller shaft of the spac tooling is coming loose. This will damage the mandrel stems. We recommend that removable thread locking compound (blue #242) be applied to the screw to prevent it from coming loose.

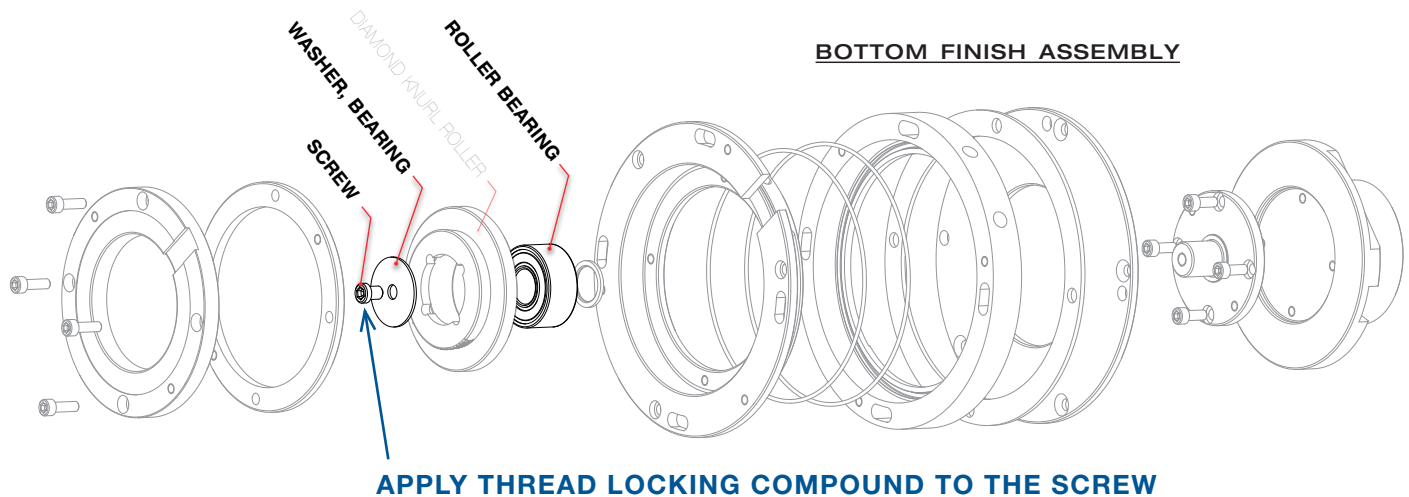

### CONTACT

Parts orders and customer communication can be made using telephone, FAX, or e-mail. See below. Contact can also be made using the **main** telephone switchboard at 414-354-8050 or FAX number 414-354-8614. Sending a FAX **directly** to the Service Department, at 414-354-1710, will convey a faster response. If using e-mail and no response is made within 3 working days, please contact via phone or FAX.

**MIKE FERGUSON**  
 TECHNICAL SERVICE  
 & TRAINING  
 414-362-8228  
[mferguson@papermc.com](mailto:mferguson@papermc.com)

**BILL PAPLHAM**  
 TECHNICAL SERVICE  
 & SERVICE TRIPS  
 414-362-8271  
[bpaplam@papermc.com](mailto:bpaplam@papermc.com)

**LARRY SPENCER**  
 ELECTRICAL APPLICATIONS  
 SERVICE ENGINEER  
 414-362-8232  
[lspencer@papermc.com](mailto:lspencer@papermc.com)

**VICKY ALCARAZ**  
 PARTS SERVICE  
 414-362-8263  
[valcaraz@papermc.com](mailto:valcaraz@papermc.com)

**JESSICA MOJICA**  
 PARTS SERVICE  
 414-362-8227  
[jmojica@papermc.com](mailto:jmojica@papermc.com)

**HOLLY WARNER**  
 PARTS SERVICE  
 414-362-8259  
[hwarnar@papermc.com](mailto:hwarnar@papermc.com)

Please make sure to carbon copy (CC) Holly Warner, Vicky Alcaraz and Jessica Mojica in **all** e-mails containing parts orders, and carbon copy (CC) **both** Mike Ferguson and Bill Paplham in **all** other e-mails.