

SERVICE BULLETIN

PAPER MACHINERY CORPORATION

address 8900 WEST BRADLEY ROAD MILWAUKEE, WI 53224-2822 · mailing P.O. BOX 240100 MILWAUKEE, WI 53224-9005
 telephone 414-354-8050 · main FAX 414-354-8614 · service FAX 414-354-1710 · website WWW.PAPERMC.COM

131106

AB POWER FLEX 700 AC DRIVE

241.1

CHECKING DYNAMIC BRAKE RESISTOR FOR FAILURE ALL PLC CONTROL MACHINES

This is for all customers running machines with AB power Flex 700 AC Drive; PMC part #EL-12721; Model year 2000 to present.

If it has been observed that the machine may be taking a long time to stop from an E-stop condition. It might be that the internal braking resistor has failed on the main drive.

To check if the resistor is still good, please do the following:

WARNING!

Only experienced electrical personnel should check the equipment. There are potentially hazardous/deadly voltages inside the enclosure. Use extreme caution.

1. Power off the main disconnect and place a lockout/tagout on the machine.
2. Wait 10 minutes to have all power dissipated from the components.
3. Open the cabinet and open the drive cover by sliding the latch in the upper corner up.
4. On the bottom of the drive are a number of terminals as shown in the picture.
5. The braking resistor is wired to terminal BR1 and BR2. Check with a voltmeter to make sure there is no voltage still on the terminals.
6. Carefully remove one wire from either BR1 or BR2. This will isolate the resistor from the circuit.
7. Checking for resistance, check across the wires of the resistor (the loose wire that is disconnected and the wire still connected to the other BR terminal). If the resistance is infinite (open circuit) the resistor has failed and needs replacement (part #20BD-DB1-2).
8. To replace, refer to the pictorial instructions from the manufacturer in the attached document.
9. After testing/replacement, reconnect the wires from the resistor to the terminals BR1 and BR2.
10. Close the cover and close the enclosure. Power on the machine and test for functionality.

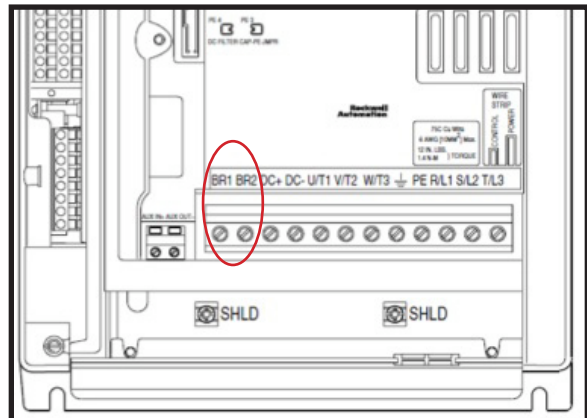

SERVICE BULLETIN

PAPER MACHINERY CORPORATION

address **8900 WEST BRADLEY ROAD MILWAUKEE, WI 53224-2822** · mailing **P.O. BOX 240100 MILWAUKEE, WI 53224-9005**
 telephone **414-354-8050** · main FAX **414-354-8614** · service FAX **414-354-1710** · website **WWW.PAPERMC.COM**

CONTACT

Parts orders and customer communication can be made using telephone, FAX, or e-mail. See below. Contact can also be made using the *main* telephone switchboard at 414-354-8050 or FAX number 414-354-8614. Sending a FAX *directly* to the Service Department, at 414-354-1710, will convey a faster response. If using e-mail and no response is made within 3 working days, please contact via phone or FAX.

MIKE FERGUSON

TECHNICAL SERVICE
& TRAINING

414-362-8228

mferguson@papermc.com

STEVE EVANS

SERVICE
COORDINATOR

414-362-8271

sevans@papermc.com

VICKY ALCARAZ

SUPPORT COORDINATOR
& EXPEDITER

414-362-8263

valcaraz@papermc.com

JESSICA MOJICA

PARTS SERVICE

414-362-8227

jmojica@papermc.com

DANIELLE TRUE

PARTS SERVICE

414-362-8260

dtrue@papermc.com

Please make sure to carbon copy (CC) Jessica Mojica and Danielle True in *all* e-mails containing parts orders, and carbon copy (CC) *both* Mike Ferguson and Steve Evans in *all* other e-mails.



PowerFlex 700 Internal Dynamic Brake Kits
Interne Bremswiderstände für PowerFlex 700
Kits de Freinage Dynamique Interne pour PowerFlex 700
Kit Interno per Frenatura Dinamica PowerFlex 700
Accesorio para Freno Dinámico Interno
PowerFlex 700 Interne Dynamische-remsets
Kits de Frenagem Dinâmica Interna do PowerFlex 700

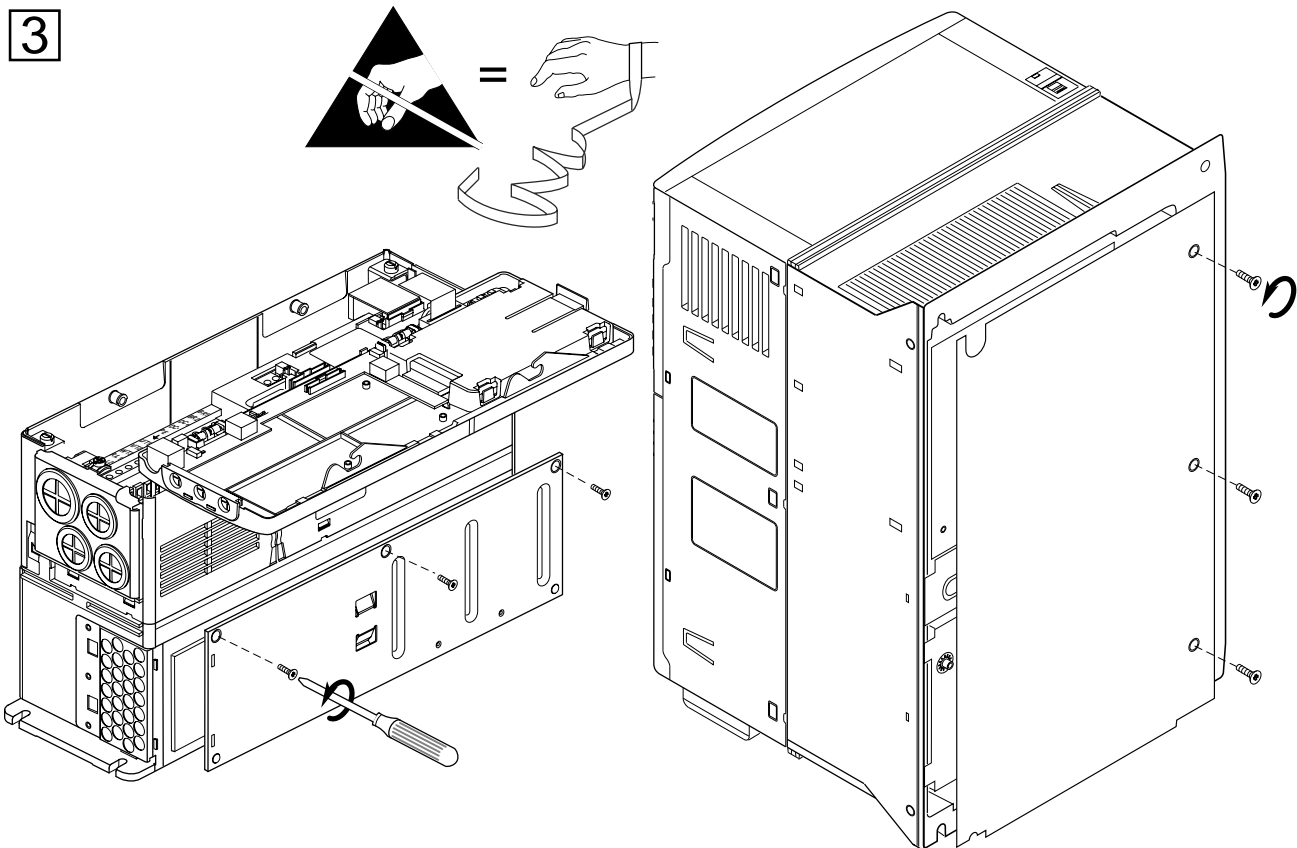
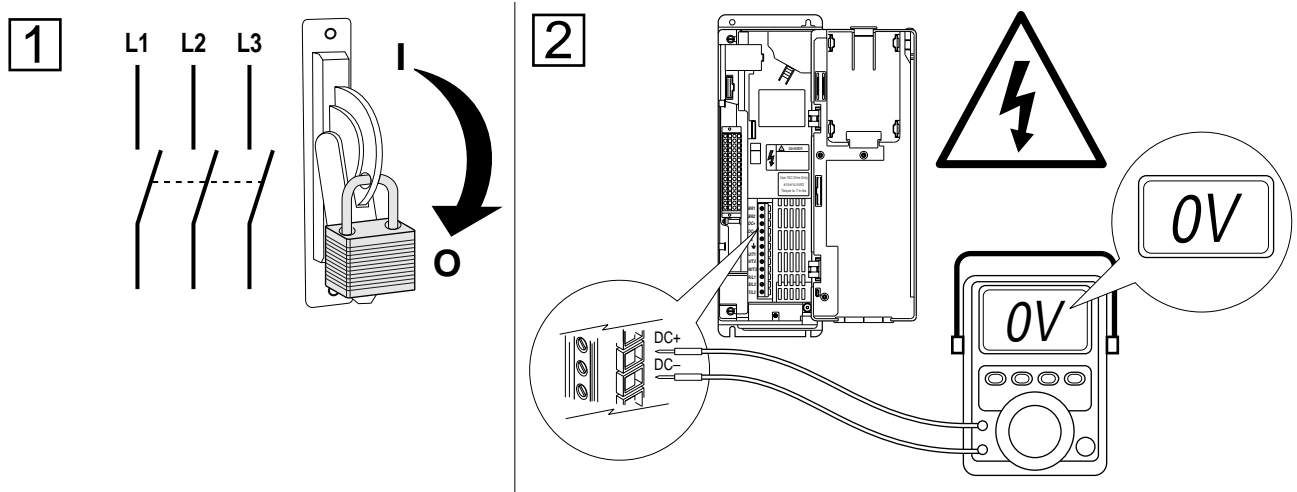

Frame 0
Baugröße 0
Taille 0
Quadro 0
Tamaño 0
Frame 0
Gabinete 0

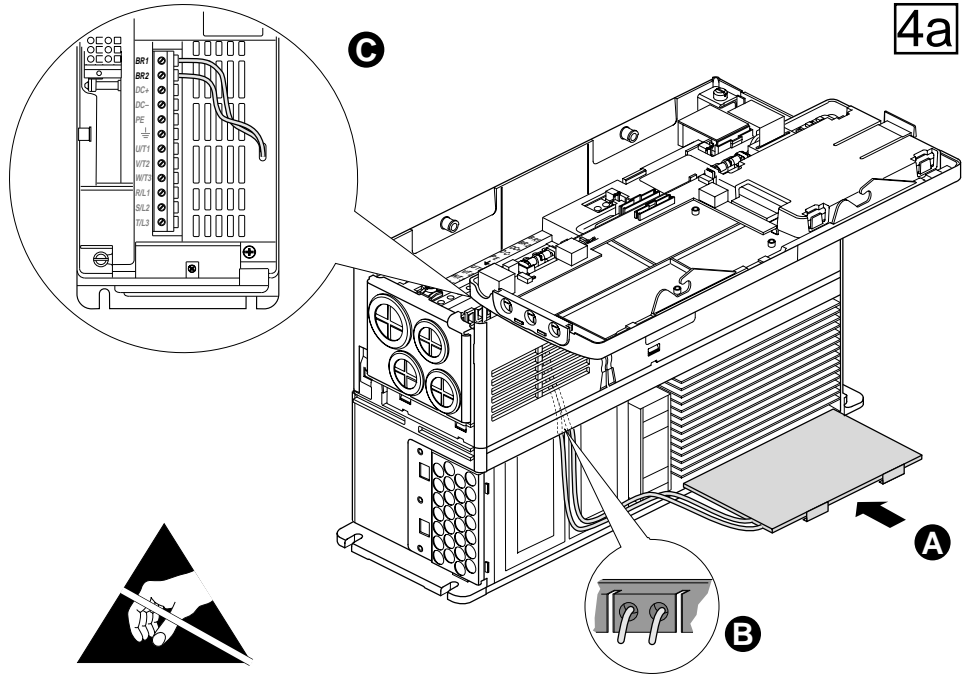

Frame 1
Baugröße 1
Taille 1
Quadro 1
Tamaño 1
Frame 1
Gabinete 1

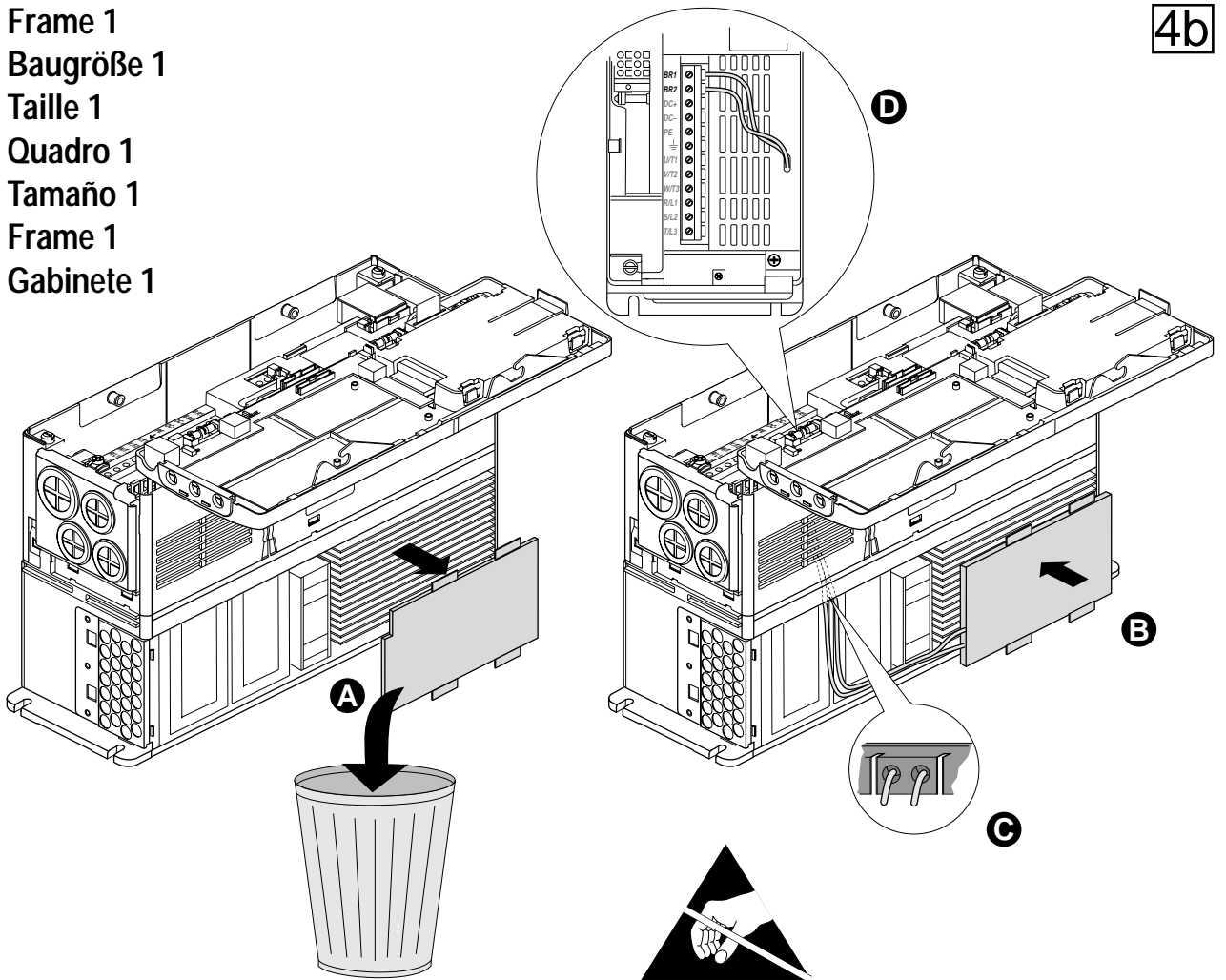

Frame 2
Baugröße 2
Taille 2
Quadro 2
Tamaño 2
Frame 2
Gabinete 2

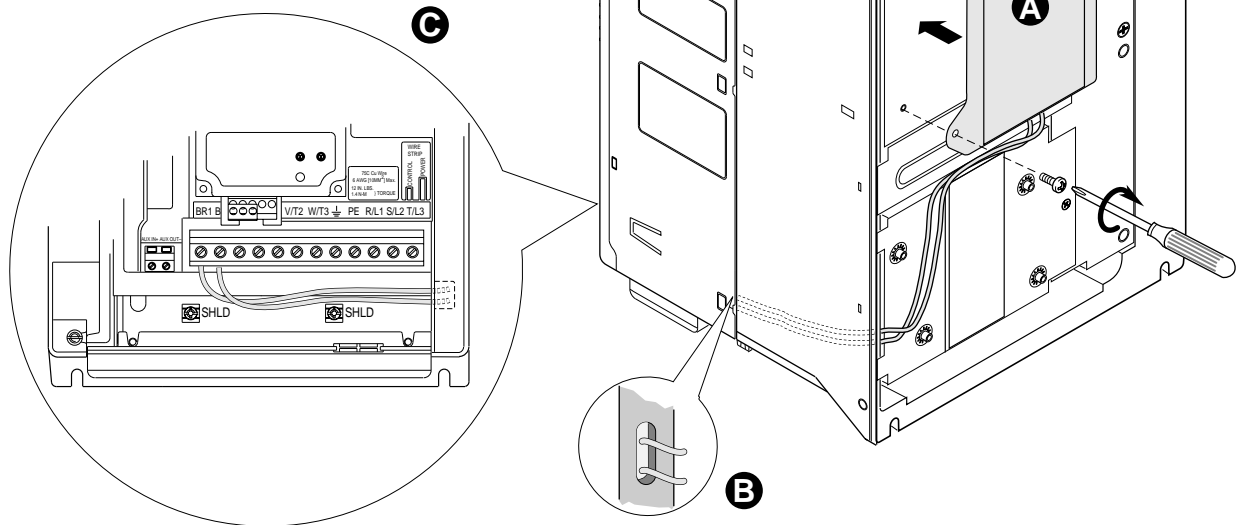
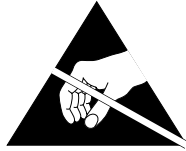

5

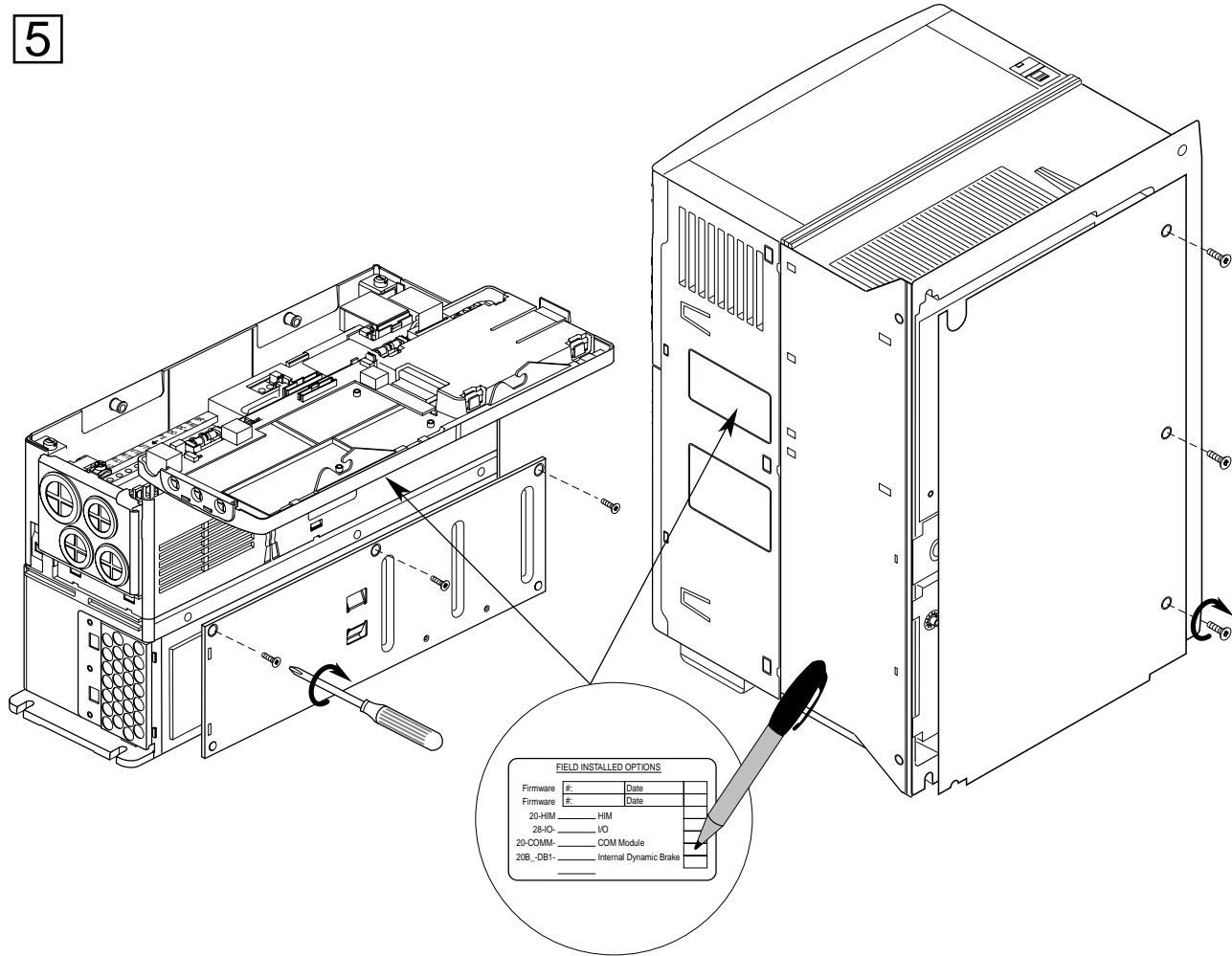

www.rockwellautomation.com

Power, Control and Information Solutions Headquarters

Americas: Rockwell Automation, 1201 South Second Street, Milwaukee, WI 53204-2496 USA, Tel: (1) 414.382.2000, Fax: (1) 414.382.4444
Europe/Middle East/Africa: Rockwell Automation, Vorstlaan/Boulevard du Souverain 36, 1170 Brussels, Belgium, Tel: (32) 2 663 0600, Fax: (32) 2 663 0640
Asia Pacific: Rockwell Automation, Level 14, Core F, Cyberport 3, 100 Cyberport Road, Hong Kong, Tel: (852) 2887 4788, Fax: (852) 2508 1846

Publication 20B-IN001B-MU-P – November, 2001
Supersedes 20B-IN001A-MU-P – August, 2001

P/N 310193-P02
Copyright © 2001 Rockwell Automation. All rights reserved. Printed in USA.